

### → Road Stud SR- 45



#### PRODUCT IDENTIFICATION

|                            |                 |
|----------------------------|-----------------|
| Product                    | SR-45           |
| Functional Characteristics | Wired Road Stud |

#### FEATURES

|                                     |  |
|-------------------------------------|--|
| Advantages                          | <p>Ideal for areas of snow;<br/>                 Robust construction, suitable for harsh conditions;<br/>                 High Brightness day or night;<br/>                 100% waterproof;<br/>                 LEDS high brightness with colour calibration with different colours;<br/>                 System wired for solar power or grid;<br/>                 Possibility of connection of n elements;<br/>                 Variable distance cables;<br/>                 Automatic cleaning;<br/>                 Low maintenance;<br/>                 Possibility of integration with device control traffic;<br/>                 Unidirectional Operation;<br/>                 LEDS protected by polycarbonate window;<br/>                 Multiples mode of operation;<br/>                 Very easy replacement: Base (Fixed on the ground), Main Body (Removable);<br/>                 Programmable functions;<br/>                 PC remote controlling;<br/>                 Communication protocol;<br/>                 Variable brightness;<br/>                 Operating time programmable.</p> |
| Modes of Operation                  | <p>Always On<br/>                 Flashing<br/>                 Sequential</p>   |
| Communication protocol Master/Slave | <p>Communication RS485 (Optional)<br/>                 Communication CAN-BUS (Optional)</p>  |

#### ELECTRICAL FEATURES

|                     |   |
|---------------------|---|
| Power               | <p>12 Vdc<br/>                 24 Vdc</p>                   |
| Current Consumption | 80 mA   |
| Cable Connection    | <p>Brown / Red (+)<br/>                 Blue / Gray (-)</p> |

### OPTICAL FEATURES

|                      |  |               |                                       |                                       |  |
|----------------------|--|---------------|---------------------------------------|---------------------------------------|--|
| Number of LEDs       | 12 LEDs 5 mm (White, Blue, Green)            |               |                                       |                                       |  |
|                      | 8 LEDs 5 mm (White, Blue, Green, Amber, Red) |               |                                       |                                       |  |
| Type LEDs            | CREE 5 mm                                    |               | NICHIA 5 mm / 3 mm                    |                                       |  |
| Colour LED           | Amber  | Red           | White                                 | Blue                                  | Green                                  |
| Viewing angle        | 15°  | 15°           | 15° (5 mm)<br>20° (3 mm)              | 15° (5 mm)<br>15° (3 mm)              | 15° (5 mm)<br>15° (3 mm)               |
| Brightness Intensity | Min.:8200mcd                                 | Min.:8200mcd  | Min.:22000mcd                         | Min.:6960mcd                          | Min.:15320mcd                          |
|                      | Max.:16800mcd                                | Max.:16800mcd | Max.:31000mcd<br>(5mm)                | Max.:9750mcd<br>(5mm)                 | Max.:21650mcd<br>(5mm)                 |
|                      |  |               | Min.:5520mcd<br>Max.:7800mcd<br>(3mm) | Min.:2760mcd<br>Max.:3880mcd<br>(3mm) | Min.:9200mcd<br>Max.:13200mcd<br>(3mm) |

### MECHANICAL FEATURES

|                      |                               |                   |
|----------------------|-------------------------------|-------------------|
| Dimensions (mm)      | Diameter:                     | 160.5 mm          |
|                      | Depth:                        | 100.41 mm         |
|                      | Rising from road surface:     | 7.5 mm            |
|                      | Installation depth:           | 95 mm             |
|                      | Dimensions (visible surface): | Diameter 160.5 mm |
| Bottom part material | Aluminium                     |                   |
| Top part material    | Stainless steel or Aluminium  |                   |
|                      | Polycarbonate                 |                   |

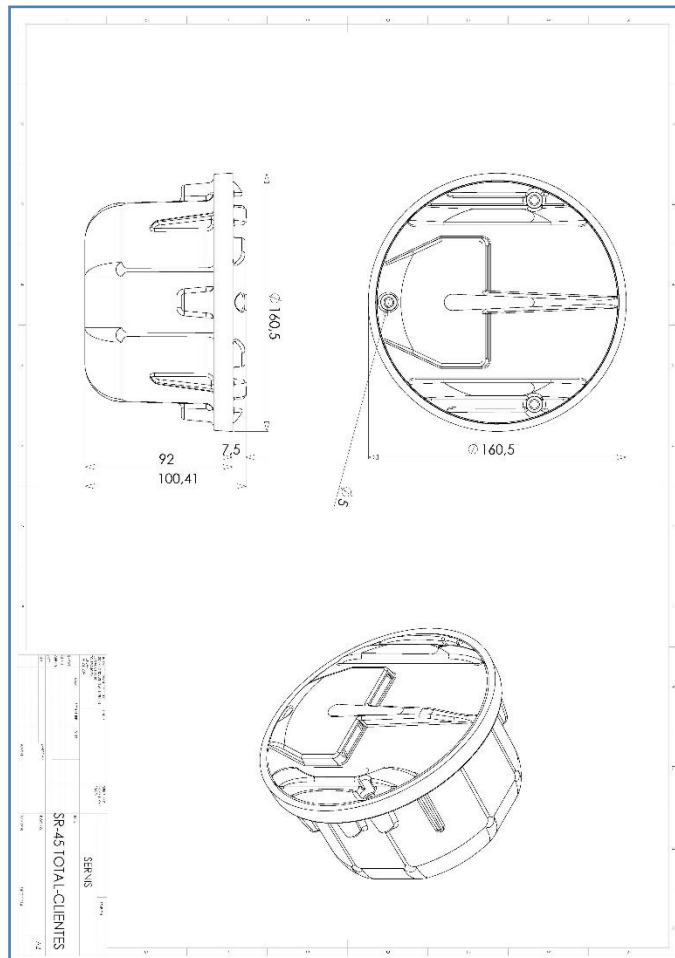

### Standard Installation Procedures:

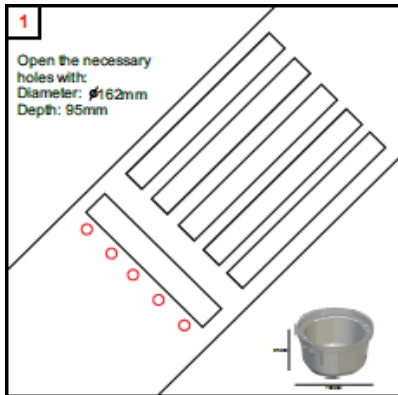

Abrir os orifícios necessários com 162mm de diâmetro e 95mm de profundidade.

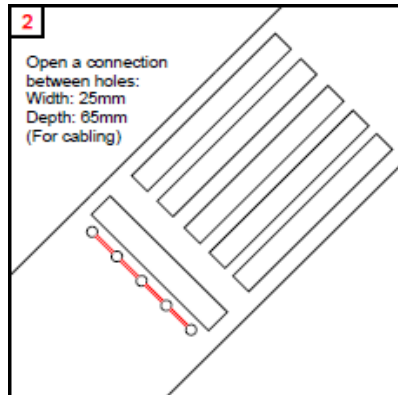

Abrir valas com 25mm de largura e 65mm de profundidade, entre os orifícios abertos previamente.

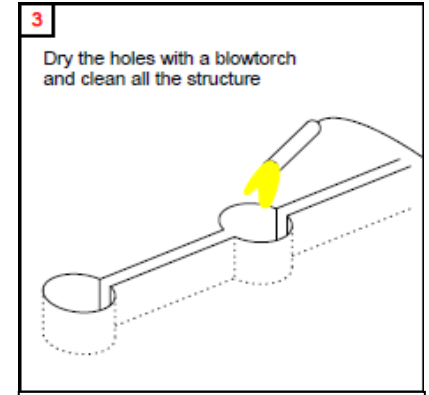

Secar os orifícios com maçarico e limpar toda a estrutura.

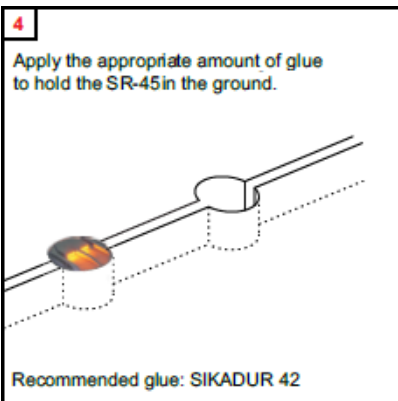

Aplicar a quantidade correta de cola para fixar os marcadores no solo.

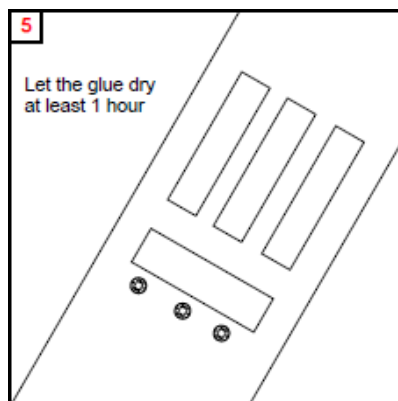

Deixar a cola secar pelo menos durante uma hora.



Aspetto final depois de concluída a instalação do SR-45.