

### → Road Stud SR-48



#### PRODUCT IDENTIFICATION

Product	SR-48
Functional Characteristics	Wired Road Stud

#### FEATURES

Advantages	<p>Ideal for areas of snow;                  Robust construction, suitable for harsh conditions;                  High Brightness day or night;                  100% waterproof;                  LEDS high brightness with colour calibration with different colours;                  System wired for solar power or grid;                  Possibility of connection of n elements;                  Variable distance cables;                  Automatic cleaning;                  Low maintenance;                  Possibility of integration with device control traffic;                  Bidirectional Operation;                  LEDS protected by polycarbonate window;                  Multiples mode of operation;                  Very easy replacement: Base (Fixed on the ground), Main Body (Removable);                  Programmable functions;                  PC remote controlling;                  Communication protocol;                  Variable brightness;                  Operating time programmable.</p>
Modes of Operation	<p>Always On                  Flashing                  Sequential</p>
Communication protocol Master/Slave	<p>Communication RS485 (Optional)                  Communication CAN-BUS (Optional)</p>

#### ELECTRICAL FEATURES

Power	<p>12 Vdc                  24 Vdc</p>
Current Consumption	160 mA
Cable Connection	<p>Brown / Red (+)                  Blue / Gray (-)</p>

### OPTICAL FEATURES

Number of LEDs	16 LEDs 5 mm (White, Blue, Green, Amber, Red)				
Type LEDs	CREE 5 mm		NICHIA 5 mm / 3 mm		
Colour LED	Amber	Red	White	Blue	Green
Viewing angle	30°	30°	15° (5 mm) 20° (3 mm)	15° (5 mm) 15° (3 mm)	15° (5 mm) 15° (3 mm)
Brightness Intensity	Min.:8200mcd	Min.:8200mcd	Min.:22000mcd	Min.:6960mcd	Min.:15320mcd
	Max.:16800mcd	Max.:16800mcd	Max.:31000mcd (5mm)	Max.:9750mcd (5mm)	Max.:21650mcd (5mm)
			Min.:5520mcd Max.:7800mcd (3mm)	Min.:2760mcd Max.:3880mcd (3mm)	Min.:9200mcd Max.:13200mcd (3mm)

### MECHANICAL FEATURES

Dimensions (mm)	Diameter:	160.5 mm
	Depth:	100.5 mm
	Rising from road surface:	8.5 mm
	Installation depth:	95 mm
	Dimensions (visible surface):	Diameter 160.5 mm
Bottom part material	Aluminium	
Top part material	Stainless steel or Aluminium Polycarbonate	

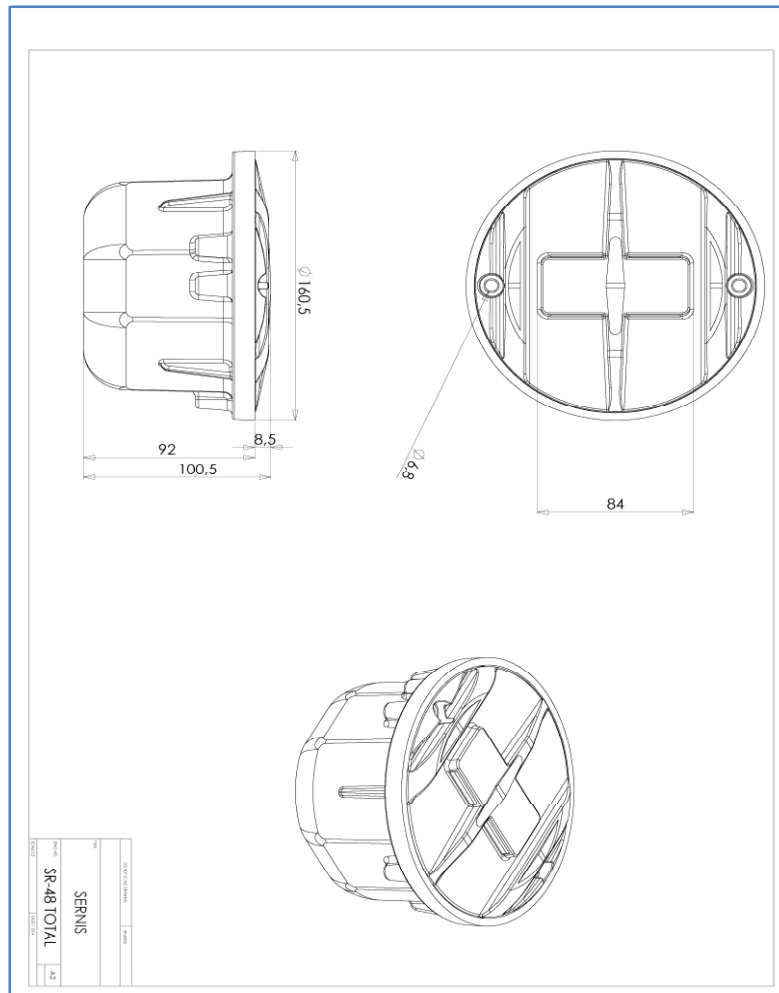

### Standard Installation Procedures:

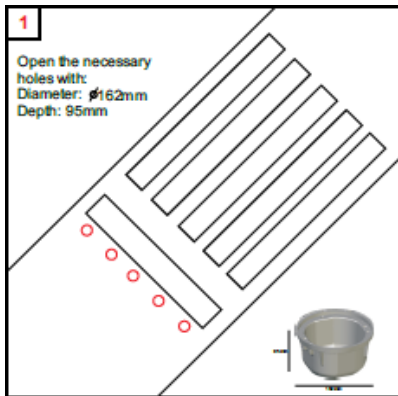

Abrir os orifícios necessários com 162mm de diâmetro e 95mm de profundidade.

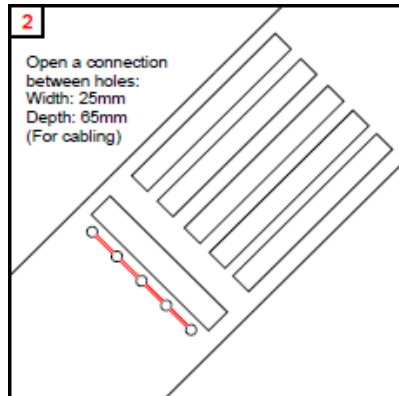

Abrir valas com 25mm de largura e 65mm de profundidade, entre os orifícios abertos previamente.

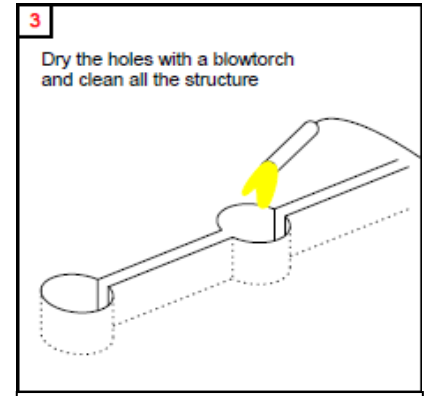

Secar os orifícios com maçarico e limpar toda a estrutura.

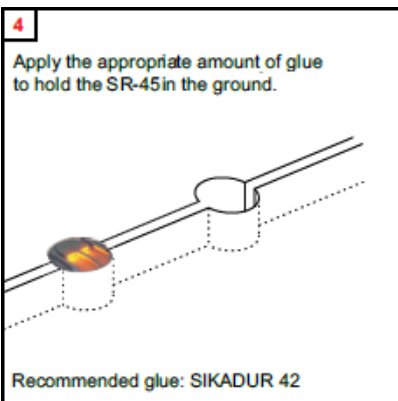

Aplicar a quantidade correta de cola para fixar os marcadores no solo.

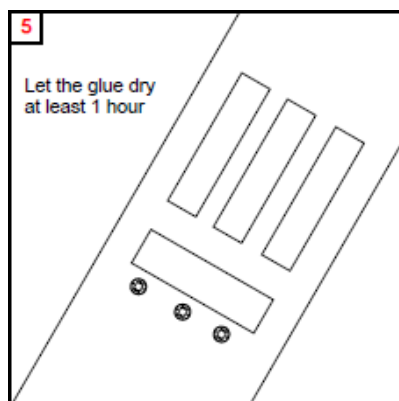

Deixar a cola secar pelo menos durante uma hora.



Aspetto final depois de concluída a instalação do SR- 48.